

HARVESTORE™ XL UNLOADER



INTRODUCING THE NEW HARVESTORE XL UNLOADER!

TODAY'S FARMING OPERATIONS REQUIRE A POWERFUL, FAST AND EFFICIENT SILO UNLOADER THAT MEETS THE DEMANDS OF MODERN FEEDING SYSTEMS. WE LISTENED TO THE NEEDS OF HARVESTORE OWNERS AND WENT BACK TO THE DRAWING BOARD. THE RESULT IS AN UNLOADER THAT IS BIGGER, BETTER AND FASTER THAN THOSE BEFORE IT, PROVIDING A VIABLE OPTION TO THE UNLOADING EFFICIENCIES PERCEIVED WITH BAGS AND BUNKERS.

OPERATIONAL FACTORS MORE TORQUE, MORE SPEED

DRIVE CAPACITY AND FORCES

The New Harvestore XL™ Unloader features significantly more power and arm drive capacity compared to Goliath® or Alliance® unloaders. It is available in 1-Phase or 3-Phase models. **New technology already incorporated in the XL Unloader control panel will run on a 1-phase 30 HP motor.**

UNLOADER DRIVE CAPACITY			
<i>Cutter Chain Load</i>	<i>Standard Speed Alliance</i> 10HP 1-Phase	<i>High Speed Alliance</i> 10HP 1-Phase	XL 30HP 1-Phase/3-Phase
Max at Start Up	17,140 lbs	21,430 lbs	25,800 lbs
Normal at High Speed	2,480 lbs	1,750 lbs	5,750 lbs
<i>Conveyor Chain Load</i>			
Max at Start Up	9,770 lbs	12,210 lbs	20,430 lbs

ARM FORCE CAPACITY			
<i>Arm Drive Capacity</i>	<i>Standard Speed Alliance</i>	<i>High Speed Alliance</i>	XL
Max at End of Arm	400 lbs	400 lbs	1,150 lbs

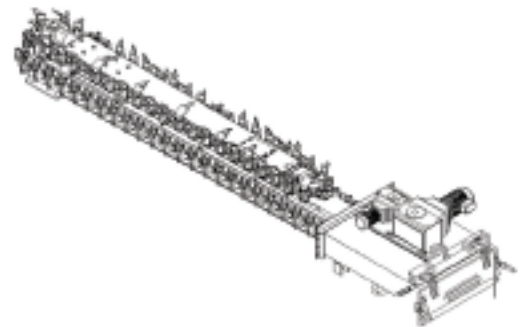

Main Drive Gear Box and Motor

SPEED RANGES

Depending on your unloading situation, the New Harvestore XL Unloader has low, high and 4 other intermediate speeds to choose from. Its main drive and arm drive systems use separate motors and separate controls (patent pending).

SPEED RANGES			
<i>Cutter Chain Speed</i>	<i>Standard Speed Alliance</i>	<i>High Speed Alliance</i>	<i>XL</i>
Low Gear Setting	80 fpm	64 fpm	57 fpm
High Gear Setting	134 fpm	190 fpm	185 fpm
<i>Conveyor Chain Speed</i>	<i>Standard Speed Alliance</i>	<i>High Speed Alliance</i>	<i>XL</i>
Low Gear Setting	141 fpm	113 fpm	73 fpm
High Gear Setting	235 fpm	335 fpm	218 fpm

PATENT PENDING ARM CONTROL SYSTEM

The new Harvestore XL Unloader will feature a Load Sensing System to monitor and react to cutter arm loads. This automated design will optimize cutter arm operation.

1. A Load Cell is mounted on the Arm Drive Gear Box and monitors the force required to drive the arm.
2. The control system reads the information and signals the control to advance the arm under light loads or hold the arm under heavy loads.



Load Sensor



Arm Drive Motor and Gear Box

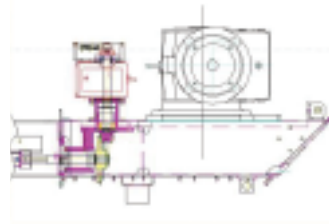

Control Box

IMPROVED CHAIN DESIGN

The new Harvestore XL Unloader will feature a new chain design (patent pending) for optimum unloading performance.

1. Similar chain used for cutter and conveyor.
2. Wider flange area on cutter arm and backbone below pin head for improved supports.

New Chain Design (patent pending)

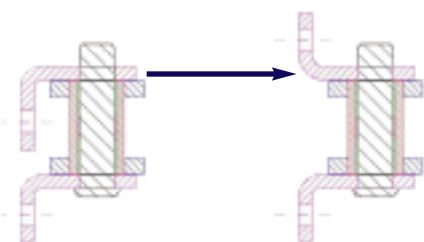

Conveyor Chain

Cutter Chain

CHAIN STRENGTHS

The New Harvestore XL Unloader features a new chain design and unprecedented strength to move greater forage volumes.

CHAIN STRENGTHS		
<i>Ultimate Chain Strength</i>	<i>Alliance</i>	<i>XL</i>
Conveyor Chain	30,000 lbs	71,500 lbs
Cutter Chain	40,000 lbs	71,500 lbs

HARVESTORE™
XL
UNLOADER

THE NEW HARVESTORE XL UNLOADER. EXPECT EXTRA LARGE PERFORMANCE.